

# ROCK BOX

the party room!

Thank you for considering the Rock Box party room for your event! This document contains details about the space as well as important information about rates, policies and washington laws. If you have further questions, give us a ring at 206.302.7625 any day after 4pm.

## capacity

For maximum comfort we suggest limiting guests to 35, though we have hosted groups upto 50 – often people come and go at different times, and parties spill into the hallway, bar and outdoor patio to chat. Another option for groups larger than 35 is to book one or more additional rooms.

## features of the space

- 60" plasma TV
- projector to display karaoke or other media on north wall
- small stage
- state-of-the-art surround sound
- user-controlled LED and laser dance lighting
- direct TV and av/media capabilities upon request

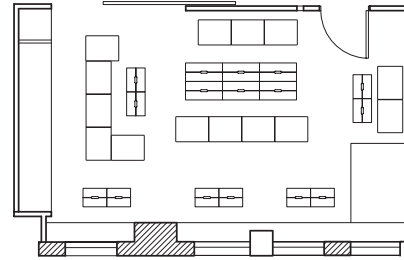

## our karaoke system

We have approximately 100,000 titles and songs in 15 languages. Our Japanese (nearly 58,000 songs) and English (20,000+ songs) libraries are our most extensive. Newly released karaoke tracks are added to our system monthly. Guests can control pitch as well as sound effects like "echo".

## party room rates

We have a two hour minimum, however most groups find they need at least three hours.

Sunday – Wednesday: \$125/hour (first two hours), \$100/hour thereafter.

Thursday: \$125/hour before 8pm and \$175/hour after 8pm (first two hours). \$125/hour thereafter.

Friday/Saturday: \$125/hour before 7pm, \$175/hour after 7pm

*Please note we require a 50% non-refundable deposit to book the room. You may change in/out time and day up until 10 days prior to the event, depending on availability.*

## fine print, additional charges, decorations

- For parties of six or more, an 18% gratuity is added to the total bill (room fees, drinks and food) assuming good service. Sales tax is also added.
- Party room fees must be on a single check; we are happy to put food/drinks on individual tabs.
- Some decorations ok, please contact us to discuss. No glitter please.

## cancellations, changes to your reservation, and late arrivals

- The room fee is a flat rate for the length of your reservation. For example, if you've booked for two hours (7 – 9pm) you will be charged for two hours regardless of when you arrive or if you leave early.
- Should you need to cancel, please do so with at least 72 hours notice to avoid being charged the room fee in its entirety.
- Other changes, please call (do not email) as soon as possible. We'll do our best to accommodate you.

## bar packages and catering options

- We offer several bar packages for hosted events (one check); information available upon request.
- Rock Box has partnered with two outstanding Capitol Hill restaurants to cater large events: Momiji (excellent Japanese including sushi) and Marination (delicious hawaiian-korean tacos and sliders). Lovely charcuterie and cheese plates from neighboring restaurant Cure are also available, as well as a few house snacks. Yumm!

## washington laws to keep in mind

- No outside beverages (alcoholic or non-alcoholic) may be brought into Rock Box.
- Individuals from abroad (other than Canadians) must bring their passport to be admitted.
- Individuals must be 21 or older to enter.
- Customers may not be in possession of alcohol after 2am; we stop serving at 1:40am nightly.



350 sf, 25' x 15'  
ceiling is 15'- 6"  
windows on nagle



last minute  
changes?  
please call rather  
than email.  
206.302.7625